



# UFT

## ULTRASONIC FULL METAL TUBULAR M30 SENSOR



- Stainless Steel AISI 316L housing
- IP68, IP69K mechanical protection degree
- ECOLAB certification
- IO-Link models



### CODE DESCRIPTION

**UFT 1 B / H 6 - 1 E IO**

|                                |            |  |
|--------------------------------|------------|--|
| series                         | <b>UFT</b> | M30 ultrasonic sensor full metal   |
| housing type                   | <b>1</b>   | Standard housing   |
| nominal sensing distance $S_n$ | <b>B</b>   | 250 - 2,500 mm direct diffuse  |
| adjustment                     | <b>H</b>   | Remote teaching via cable  |
| output                         | <b>1</b>   | 0...10 V single voltage analogue output  |
|                                | <b>2</b>   | 4...20 mA single current analogue output   |
|                                | <b>P</b>   | PNP - NO/NC digital output   |
|                                | <b>W</b>   | PNP + IO-Link, two digital outputs with standard window and adjustable hysteresis function |
|                                | <b>6</b>   | 4 ... 20 mA current analogue output + IO-Link  |
|                                | <b>7</b>   | 0 ... 10 V voltage analogue output + IO-Link   |
| housing material               | <b>1</b>   | Axial AISI 316L (DIN 1.4404) stainless steel housing                                       |
| cable / exit connector         | <b>E</b>   | M12 plug cable exit  |
| communication protocol         | <b>IO</b>  | IO-Link  |

# UFT TECHNICAL SPECIFICATIONS

CYLINDRICAL  
SENSORS

## UFT1B/H\*-1E\*\*

| GENERAL DATA                      |  |
|-----------------------------------|--|
| Operating principle               | Diffuse reflection   |
| DETECTION CAPABILITIES            |  |
| Nominal sensing distance          | 250 ... 2500 mm  |
| Thermal drift                     | +/- 5%   |
| Repeatability                     | 1%   |
| Hysteresis                        | 3%   |
| EMISSION DATA                     |  |
| Beam angle                        | 11 °   |
| FUNCTIONS                         |  |
| Sensitivity adjustment            | Remote Teaching via cable  |
| INPUT/OUTPUT                      |  |
| Maximum switching frequency       | 1 Hz   |
| Response time max                 | 200 ms   |
| Output type                       | 0...10V, 4...20 mA, PNP, IO-Link + 0...10V, IO-Link + 4...20 mA, IO-Link + PNP |
| Output function                   | Analogue Output, Digital Output, Io-Link + Analogue Output, Io-Link + Digital  |
| ELECTRICAL DATA                   |  |
| Supply voltage                    | 10 ... 30 V  |
| Maximum residual ripple           | 500%   |
| Short circuit protection          | •  |
| Reverse polarity protection       | •  |
| Impulsive overvoltage protections | •  |
| Delay to availability             | 300ms  |
| MECHANICAL DATA                   |  |
| Dimensions                        | M30/ L=103.05 mm   |
| Material                          | Stainless Steel AISI-316L  |
| Connections                       | M12 (UFT1B/H*-1E**)  |
| Weight                            | 175 g  |
| ENVIRONMENTAL DATA                |  |
| Operating Temperature             | -10 ... 60 °C  |
| Mechanical Protection             | IP67, IP68, IP69K  |

## AVAILABLE MODELS

| Operating principle | Nominal sensing distance | Sensitivity adjustment    | M12             |             |                           |               |                   |                |
|---------------------|--------------------------|---------------------------|-----------------|-------------|---------------------------|---------------|-------------------|----------------|
|                     |                          |                           | Analogue Output |             | Io-Link + Analogue Output |               | Io-Link + Digital | Digital Output |
| Diffuse reflection  | 250 ... 2500 mm          | Remote Teaching via cable | UFT1B/H1-1E     | UFT1B/H2-1E | UFT1B/H7-1EIO             | UFT1B/H6-1EIO | UFT1B/HW-1EIO     | UFT1B/HP-1E    |

# RESPONSE DIAGRAMS

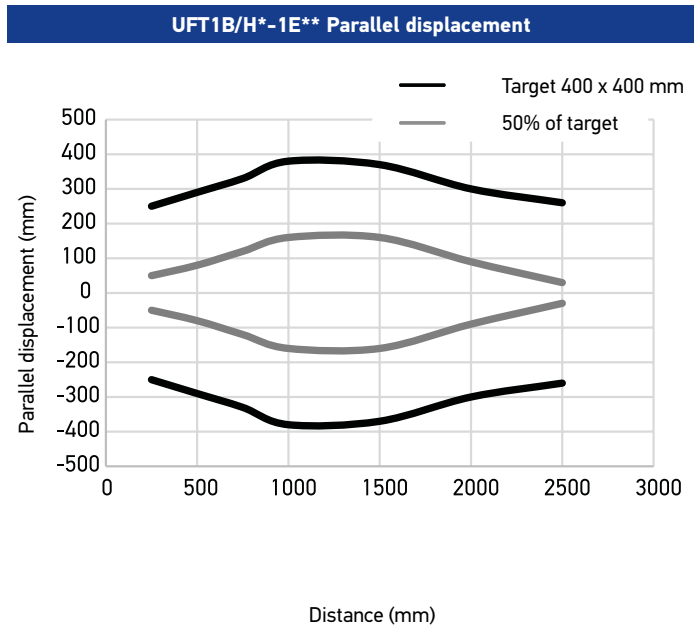

## PLUGS

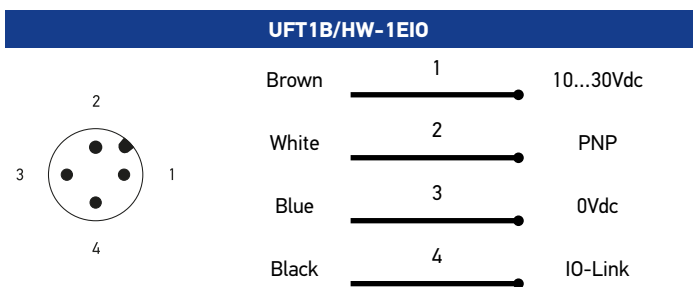
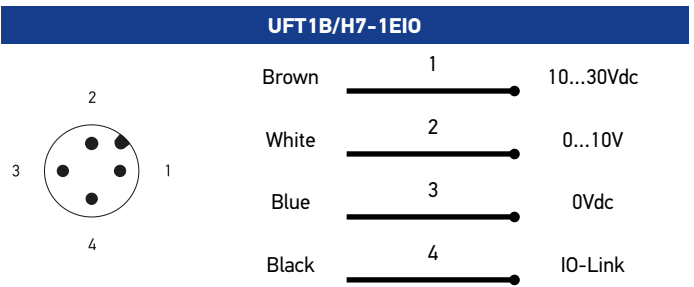
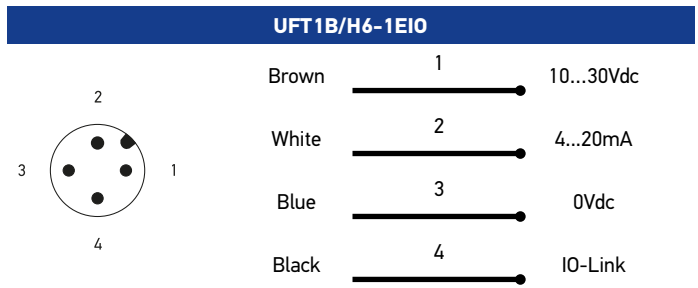
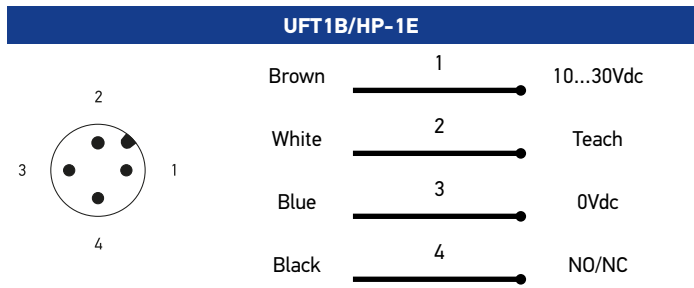
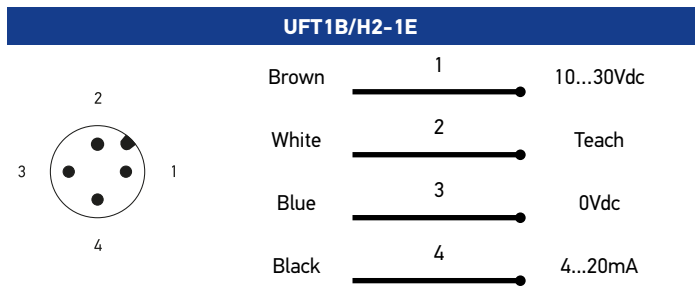
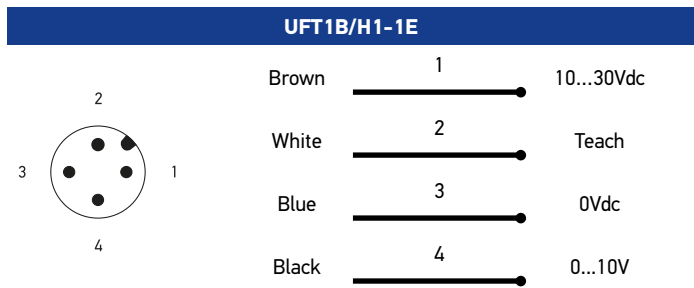

UFT1B/H\*-1E\*\*

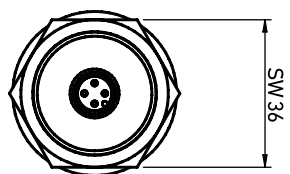
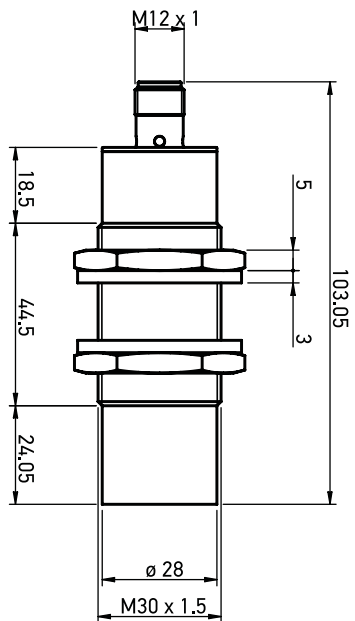

(mm)